

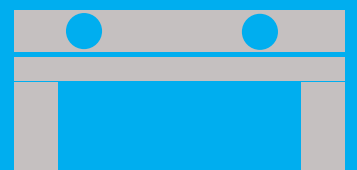

INSTALLING THE PROFIX SYSTEM ON TIMBER FLOORS



Timber Floors

Profix™

ASSESS THE TIMBER FLOOR

1. Timber substrates

Profix levelling compound is used to encapsulate, fill and smooth Profix Panels which have been securely fixed to the existing timber substrate in accordance with Profix instructions. After assessment of the substrate and completion of the required pre-treatment, the Profix Panels should be mechanically fixed to the substrate ensuring that they are flat and in contact with the substrate. There should be no movement or flexing of the floor when walked on.

Ensure that the floor is capable of supporting the required loads without deflection. Deflection can be measured under load or assessed visually by jumping up and down on the floor. The floor must be stable, well supported and ventilated underneath. If the timber floor is sound and there is no flexing under load, check that the boards are butted together and that there are no gaps between boards, nor any holes or leaks in the floor where the flowing screed can flow away when applied. The substrate can now be prepared and primed as described in the next section "Prepare the timber floor"

Prime the floor only



Timber floors which flex or move under load when walked on will need to be repaired prior to installation of the Profix low profile screed system. Localised damaged boards should be replaced. Where the existing floor flexes under load it will need to be over-boarded using a minimum 6mm board e.g plywood.

Overboard and Primer

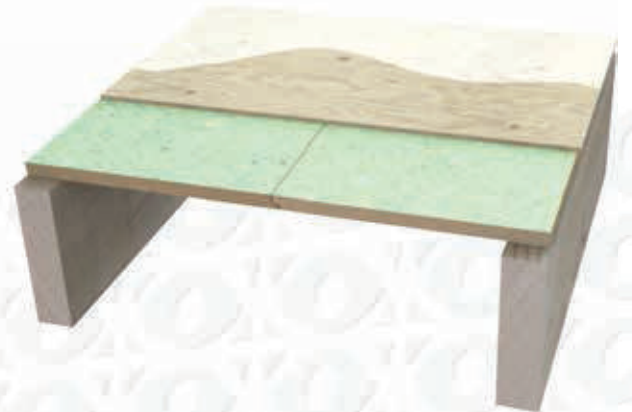

Solid timber floors with no movement under load, but gaps between boards where screed can leak during installation can be over laid with Profix high compressive strength extruded polystyrene either 6mm or 10mm thick

Insulation with no Primer



PREPARE THE TIMBER FLOOR

1. Timber substrates

STEP 1

The substrate should be swept clean of any dust / debris.



STEP 2

The substrate should be primed using Profix dispersion primer diluted in accordance with the datasheet. The primer is spread using a soft sweeping brush. Profix panels can be applied after the primer has become touch dry, and the Profix levelling compound should be applied within 72 hours.



STEP 3

A soft strip (5mm minimum in thickness) is fixed to any wall or vertical element in the floor

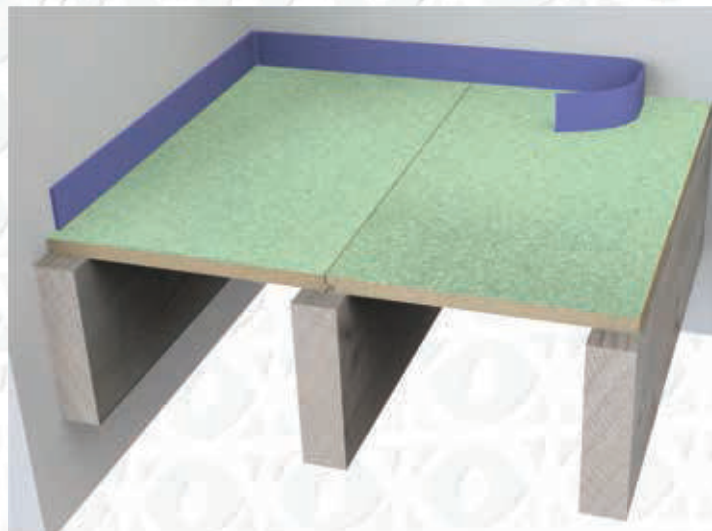

INSTALL THE PROFIX PANELS

1. Timber substrates

STEP 4

Before placing the first panel within the corner of the room, remove all tabs on the one edge of the panel (see image to the right). This ensures that the protruding tab does not pierce the edge insulation.

All subsequent panels within the first row must have the tab removed.



STEP 5

Place the first panel within the corner ensuring the male snap clip is facing from left to right.

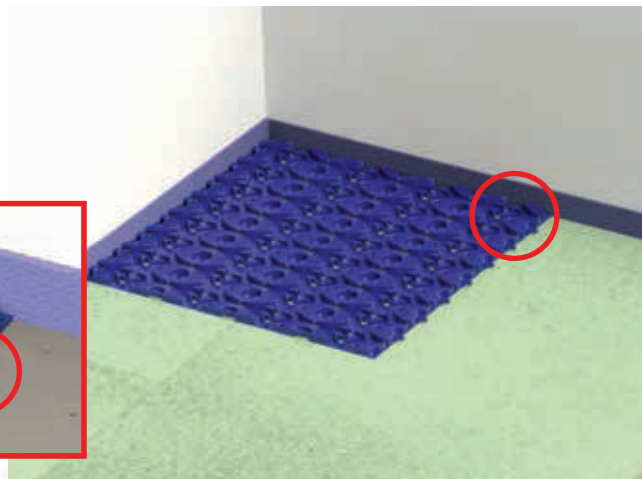
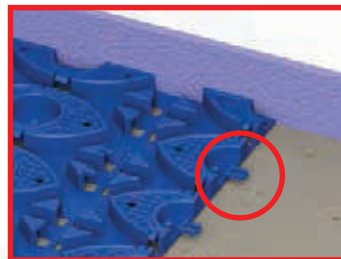

STEP 6

Mechanically fix the panels to the floor using a cordless screwdriver and wood screws



INSTALL THE PROFIX PANELS

1. Timber substrates

STEP 7

Click the next panel into place using the male snap clips until fully engaged.

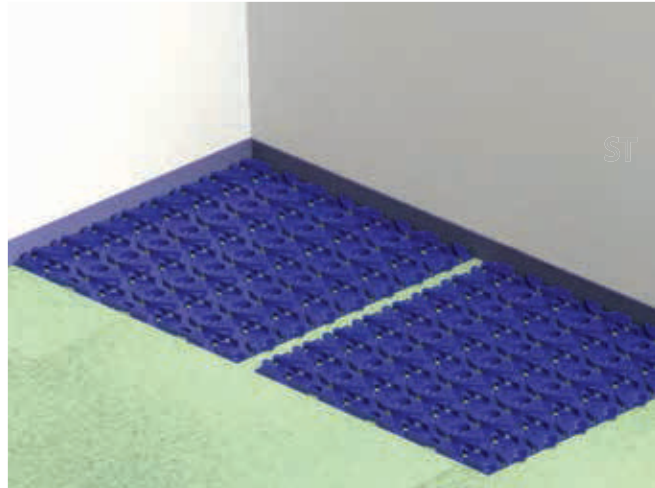
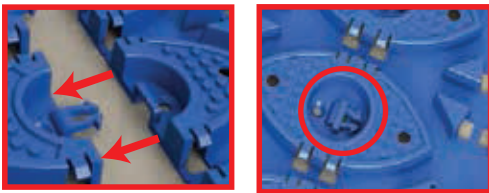

STEP 8

Complete the whole row of panels until you reach the edge of the room



When you reach the edge of the room, measure the remaining distance and score the back of the panel using one of the pre grooved cutting lines.

Snap the required section of panel and lock in place.

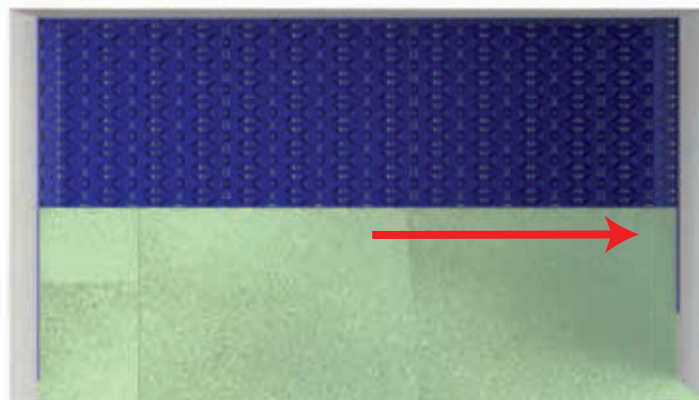

INSTALL THE PROFIX PANELS

1. Timber substrates

STEP 9

Upon completion of the first row, the next panel is connected to the first panel of row 1 using the slide and lock feature.

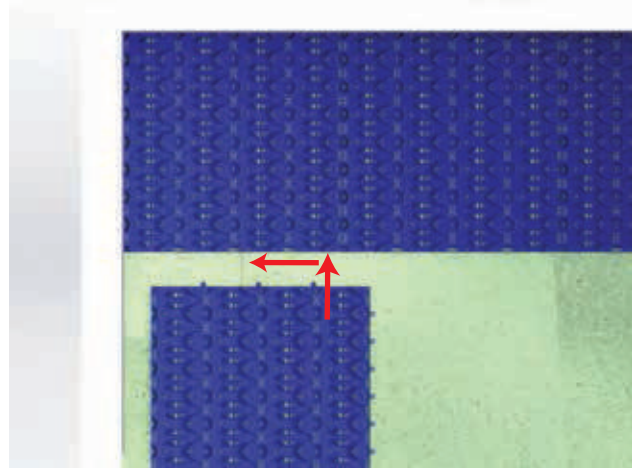

STEP 10

Continue to lay the panels across the room repeating the process until the room is completed.



STEP 11

Laying the pipework- Starting from the manifold, lay the first circuit by pressing the pipework into the panel through the integral pipe clips in a meandering pattern. The grooves within the panel enable either 150mm or 75mm pipe centres.

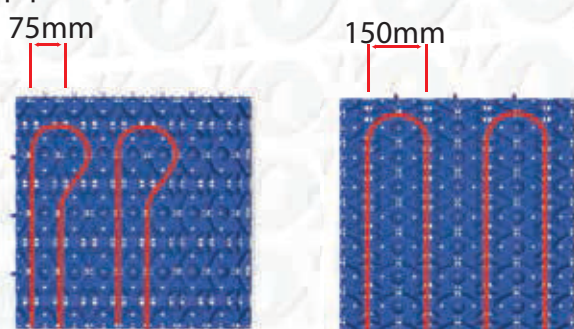

Ideally use a rubber mallet to fully engage the pipe work in place

INSTALL THE PROFIX PANELS

1. Timber substrates

Complete all circuits

STEP 12



STEP 13

PRE SCREEDING CHECKS-

- 1 Ensure all panels are secure to the substrate
- 2 Ensure all pipework is clipped in place and secure within the panel.
- 3 Ensure the area within the panel is completely clear of debris.
- 4 Ensure the pipework is fully pressure tested in line with the testing procedures

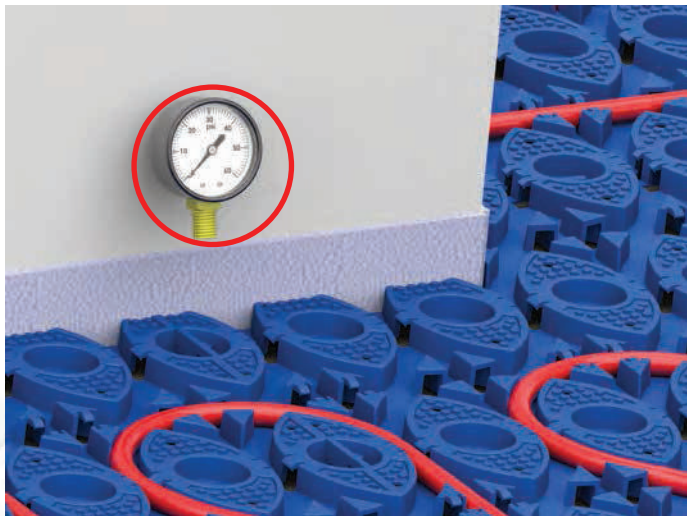

READY FOR APPLYING THE PROFIX LEVELLING COMPOUND