



## Overboard - Slim 12 Light Tile 200mm Floor Construction - FC4fg

### KEY BENEFITS >>>

- > Ideal for when underfloor heating wasn't considered
- > Lightweight
- > System is designed for easy, safe and fast pipe installation
- > Ultra thin - Only 20mm thick
- > Improves thermal performance and response times
- > Fixed down with tile adhesive for a solid movement free bed for tiles to be installed on top
- > High grade insulation that can be easily cut to allow pipe grooves in difficult shaped rooms
- > Cement skim allows tiles to be fixed with no need for bonding



### < OVERVIEW

Our Overboard tile is a light weight insulation panel with the same properties of the Overboard Slim 12 but the foil faced insulation covering has been replaced with a cement skim so tiles can be laid directly on top. The product does not require any overboard returns.

The insulation panel is sandwiched between two cement skim layers similar to tile backer board. The panel is fixed down with tile adhesive on top of either solid or timber floors. The tile can be installed on top creating a solid movement free floor.

- Best suited for FlexiPex 16mm Pipe
- Maximum Outputs :- 55w/m<sup>2</sup>
- Flow Temperature :- 48 - 60°C
- For high temperature heat sources

### PRODUCT LIST >

#### Overboard - Slim 12 light

SIZE	QTY	PRODUCT CODE
Luxusheat Overboard Slim 12 Light 20mm(1200x600x20mm)	1	TB72016200





## Overboard - Slim 12 Light Tile Floor Construction - FC4e

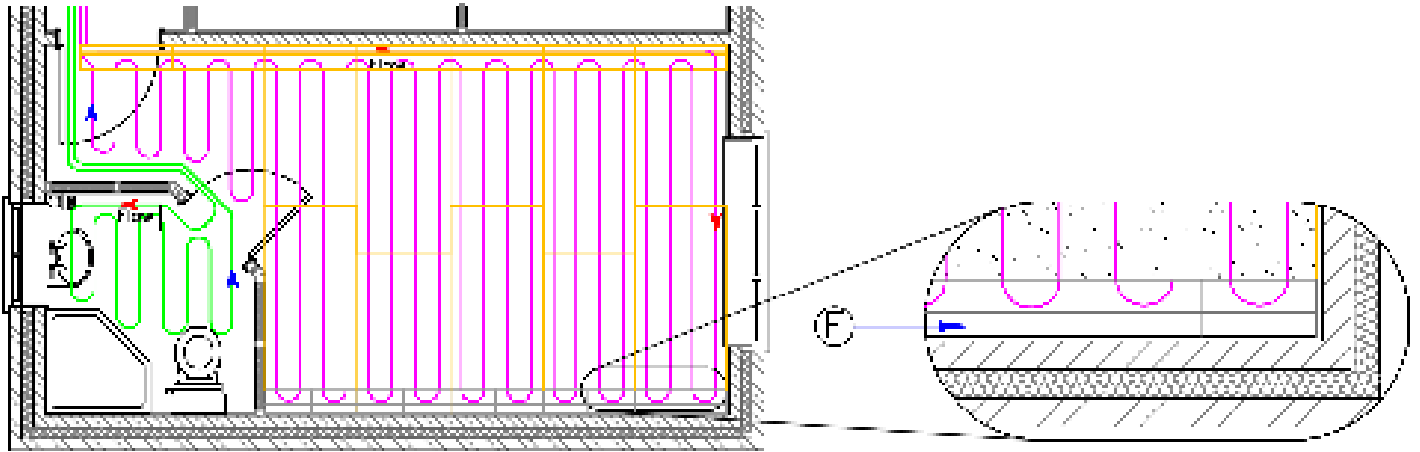

PLAN VIEW 

SECTION OF FLOOR BUILD UP 

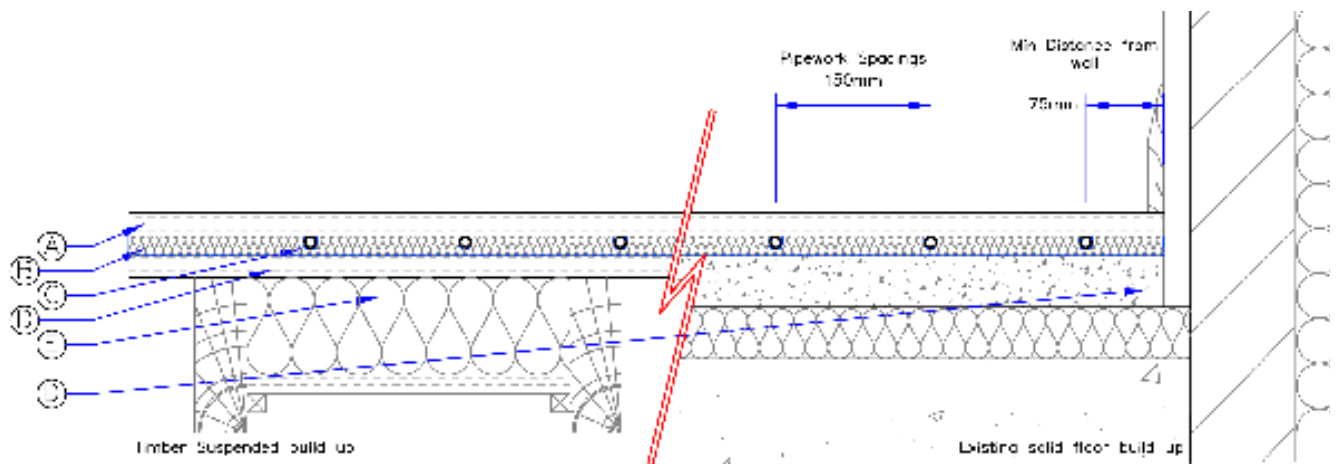

- A >** Floor Finish.
- B >** Grooved and Cement backed insulation board (800 x 600 x 20mm) fixed to a flat surface with cement based tile adhesive
- C >** **UFH Pipe** - FlexiPex 16mm Heating Pipework laid at 200mm centres in pre-grooved slots and laid approximately 75mm away from walls.
- D >** Existing floor build up.
- E >** Insulation between joists.
- F >** Plastic end return screwed through to existing floor

### INSULATION TECHNICAL DATA

Extruded Polystyrene - Grade XF250 ( BS EN 13164)  
Grooved at 200mm Centres for 16x2mm FlexiPex

Thermal Conductivity: 0.033 W/mK

Compressive Strength: 300kPa @ 10% Compression

Fire Classification: Euroclass E



## Overboard - Slim 12 Light Tile Floor Construction - FC4e

### OUTPUTS/WATER TEMPERATURES >

The available output of the system will vary depending on the overall resistance of the floor finish. The table below is for guidance only and actual outputs and temperatures may vary slightly.

### FLOOR FINISHES >

The table below summarises acceptable thermal resistance for typical floor finishes adhering to the BS EN 1264 Part 2. Tog value is a textile industry measure of thermal resistance 1 tog = 0.10m<sup>2</sup> K/W

Heat output / Flow water Temperature (Slim 12 Light Tile)

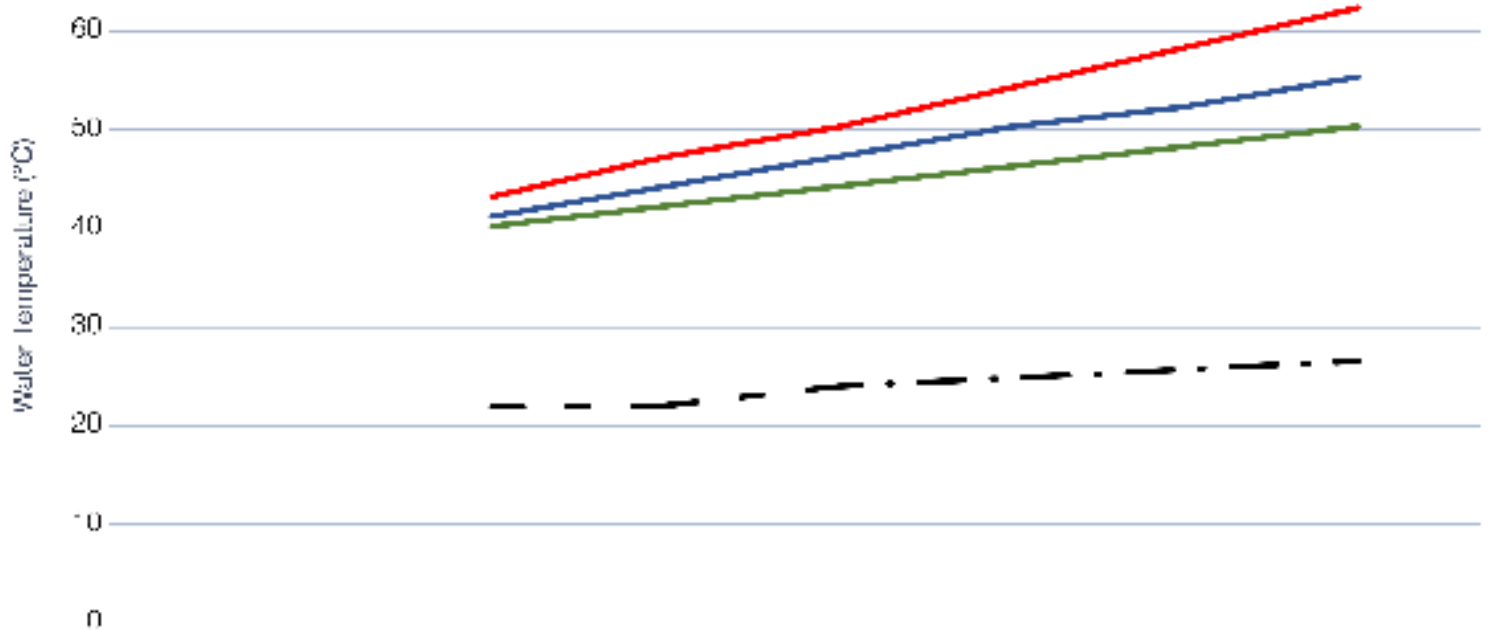

	Output w/m <sup>2</sup>						
	20	30	40	50	60	70	
— Tile / Stone	40	42	43	46	48	51	Water Temp: (°C)
— Laminate / Vinyl	41	44	47	50	52	55	
— Carpet	43	47	50	54	58	61	
— Floor Temp	22	22	24	25	26	27	